

# Atlantic

## Exit Sign DALI Wireless

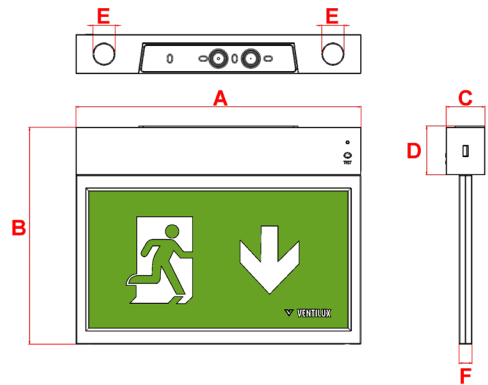

<b>30m</b> Viewing Distance	<b>IP 40</b>	<b>LiFePO4</b> Battery	<b>Wall and Ceiling</b> Mounting
<b>1.2Kg</b>	<b>5700K</b>	<b>Class II</b>	<b>8Y</b> Warranty

Order Code	<b>ATM3/LED/DAW</b>
Mode of operation	Maintained
DALI Interface	For Controlled Monitoring and Reporting
Emergency duration	3 hours
Input voltage	230/240V (207VAC - 264VAC) 50/60Hz
Power consumption	5.5VA, I <sub>nom</sub> = 23mA (Full Battery)
Battery type	Rechargeable LiFePO4 Battery 3.2V 3.2Ah
Battery low voltage cut off	2.5V DC
Battery discharge current @ 3.2V DC	0.5A
Lamp	1W
Lamp colour	5700K
Viewing Distance	30m
Lamp Lifetime	L <sub>80 B50</sub> 80000 Hours
Nominal lamp voltage	V <sub>rated</sub> = 3V DC
Nominal lamp current	I <sub>rated</sub> = 0.35A CC
Nominal lamp power	P <sub>rated</sub> = 1W
Maximum output voltage with no lamp connected	U-OUT = 5V DC
Ingress protection	IP40
Cable entry	20mm on top and rear of product
Luminaire class	Class II
Product Weight	1.44Kg
Packaging Weight	0.24Kg
Standards	EN61347-2-7, EN61347-2-13, EN 60598-2-22, EN 55015
Environment	0°C to 45°C up to 80% relative humidity.

## Materials

Housing: ABS  
Decal Legend: Polypropylene

Standard Colour: White - RAL 9016  
Alternative Colours Available Upon Request

## Warranty

Standard Warranty: 8 Years  
Alternative Warranty: 10 Years  
Add /10Y to order code

System	Order Code	Mode of Operation	Battery	Battery P/N	Viewing Distance	Dimensions (mm)					
						A	B	C	D	E	F
<b>DALI Wireless</b>	<b>ATM3/LED/DAW</b>	<b>Maintained</b>	<b>LiFePO4 3.2V, 3.2Ah</b>	<b>70261</b>	<b>30 Metres</b>	<b>330</b>	<b>275</b>	<b>60</b>	<b>80</b>	<b>26</b>	<b>15</b>
Alternative Systems Available: Specification sheets available upon request											
Standalone	AT2M3/LED	Maintained	LiFePO4 6.4V, 0.6Ah	70270	30 Metres	330	250	45	56.5	26	15
DALI	AT2M3/LED/DA	Maintained	LiFePO4 3.2V, 3.2Ah	70261	30 Metres	330	250	45	56.5	26	15
Self-Test	AT2M3/LED/ST	Maintained	LiFePO4 3.2V, 3.2Ah	70261	30 Metres	330	250	45	56.5	26	15

Available Accessories					
Order Code	Description	Material	Cutout (mm)	Dimensions(mm)	
<b>AT/RK/DAW</b>	<b>Recessing Kit</b>	<b>ABS</b>	<b>370 x 80</b>	<b>390</b>	<b>100</b>

## Included Legends



ISO 01



ISO 02

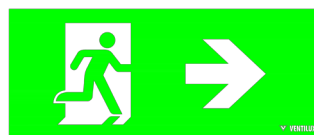

ISO 03



ISO 04