

Vasari

Wall Mounted DALI Exit

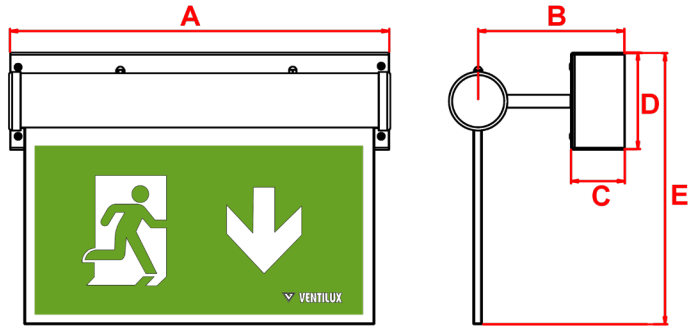

Materials

Housing: Painted Steel
Panel Legend: Acrylic

Standard Colour : **White -Add **WH** to order code
Alternative Colours: **Black -Add **BL** to order code
Brushed Chrome- Add **BCH to order code

Warranty

Standard Warranty: 6 Years
Alternative Warranty: 10 Years
Add **/10Y** to order code

Order Code	ZVAIM3LEDWM**DA
Mode of Operation	Maintained DALI
Emergency duration	3 hours
Input voltage	230/240V (207Vac - 264Vac) 50/60Hz
Power consumption	7.2VA
Battery	Rechargeable 3.6V 2.1Ah NiMh
Battery low voltage cut off	3.0Vdc
Battery discharge current @ 3.6Vdc	0.485A
Lamp	8 x High Powered White Samsung LEDs
Lamp Life	L ₈₀ B ₅₀ 80000 Hours
Nominal lamp current	I _{rated} = 0.35A
Nominal lamp power	P _{rated} = 1W
Cable entry	20mm Rear entry
Luminaire class	Class I
Weight	2.1 kg
Packaging Weight	0.15 kg
Standards	BS5266, EN62034, EN61347-2-7, EN61347-2-13, EN 60598-2-22
Environment	0°C to 45°C up to 80% relative humidity.

System	Order Code	Mode of Operation	Battery	Battery P/N	Viewing Distance	Dimensions (mm)				
						A	B	C	D	E
DALI	ZVAIM3LEDWM**DA	Maintained	3.6V 2.1Ah NiMh	70272	28 Metres	365	135	50	90	235
Alternative Systems Available:										
Standalone	VAIM3/LED/WM**	Maintained	4.8V 1.3Ah NiMh	70229	28 Metres	365	135	50	90	235
Central Battery	ZVAILEDWM**230S	Slave	n/a	n/a	28 Metres	365	135	50	90	235

Legends (Ordered Separately)



Left /Right Arrow (Left one side, Right opposite side)
PN: LPSTISO13MVL



Down Arrow (both sides)
PN: LPSTISO02MVL

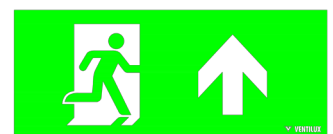

Up Arrow (both sides)
PN: LPSTISO04MVL

Additional options of Printed Panels available. Contact Ventilux for further details.