

Vasari

Wall Mounted Exit

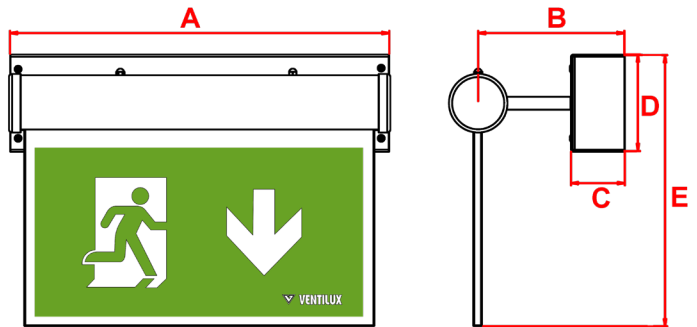

Materials

Housing: Painted Steel
Panel Legend: Acrylic

Standard Colour : **White -Add **WH** to order code
Alternative Colours: **Black -Add **BL** to order code
Brushed Chrome- Add **BCH to order code

Warranty

Standard Warranty: 6 Years
Alternative Warranty: 10 Years
Add **/10Y** to order code

| | |
|------------------------------------|---|
| Order Code | VAIM3/LED/WM** |
| Emergency duration | 3 hours |
| Input voltage | 230/240V (207Vac - 264Vac) 50/60Hz |
| Power consumption | 5VA |
| Battery | Rechargeable 4.8V 1.3Ah NiMH |
| Battery charger | Constant Current Nominal charge 0.5A |
| Battery low voltage cut off | 4.0Vdc |
| Battery discharge current @ 4.8Vdc | 0.28A |
| Battery discharging limits | up to 0.4A for 3 hours |
| Lamp | 8 x High Powered White Samsung LEDs |
| Lamp Life | L _{80 B50} 80000 Hours |
| Nominal lamp current | I _{rated} = 0.35A |
| Nominal lamp power | P _{rated} = 1W |
| Cable entry | 20mm Rear entry |
| Luminaire class | Class I |
| Weight | 2.1 kg |
| Packaging Weight | 0.15 kg |
| Standards | BS5266, EN62034, EN61347-2-7, EN61347-2-13, EN 60598-2-22 |
| Environment | 0°C to 45°C up to 80% relative humidity. |

| System | Order Code | Mode of Operation | Battery | Battery P/N | Viewing Distance | Dimensions (mm) | | | | |
|--------------------------------|-----------------|-------------------|-----------------|-------------|------------------|-----------------|-----|----|----|-----|
| | | | | | | A | B | C | D | E |
| Standalone | VAIM3/LED/WM** | Maintained | 4.8V 1.3Ah NiMH | 70229 | 28 Metres | 365 | 135 | 50 | 90 | 235 |
| Alternative Systems Available: | | | | | | | | | | |
| Central Battery | ZVAILEDWM**230S | Slave | n/a | n/a | 28 Metres | 365 | 135 | 50 | 90 | 235 |
| DALI | ZVAIM3LEDWM**DA | Maintained | 3.6V 4.5Ah NiMH | 70272 | 28 Metres | 365 | 135 | 50 | 90 | 235 |

Legends (Ordered Separately)



Left /Right Arrow (Left one side, Right opposite side)
PN: LPSTISO13MVL



Down Arrow (both sides)
PN: LPSTISO02MVL



Up Arrow (both sides)
PN: LPSTISO04MVL

Additional options of Printed Panels available. Contact Ventilux for further details.

www.ventilux.com ● sales@ventilux.ie ● sales@ventilux.co.uk (UK Enquiries Only) ● SS2-050-01

We adopt a policy of continuous product and services improvement and we reserve the right to vary details without prior notice
For Warranty Terms please visit the Ventilux website