

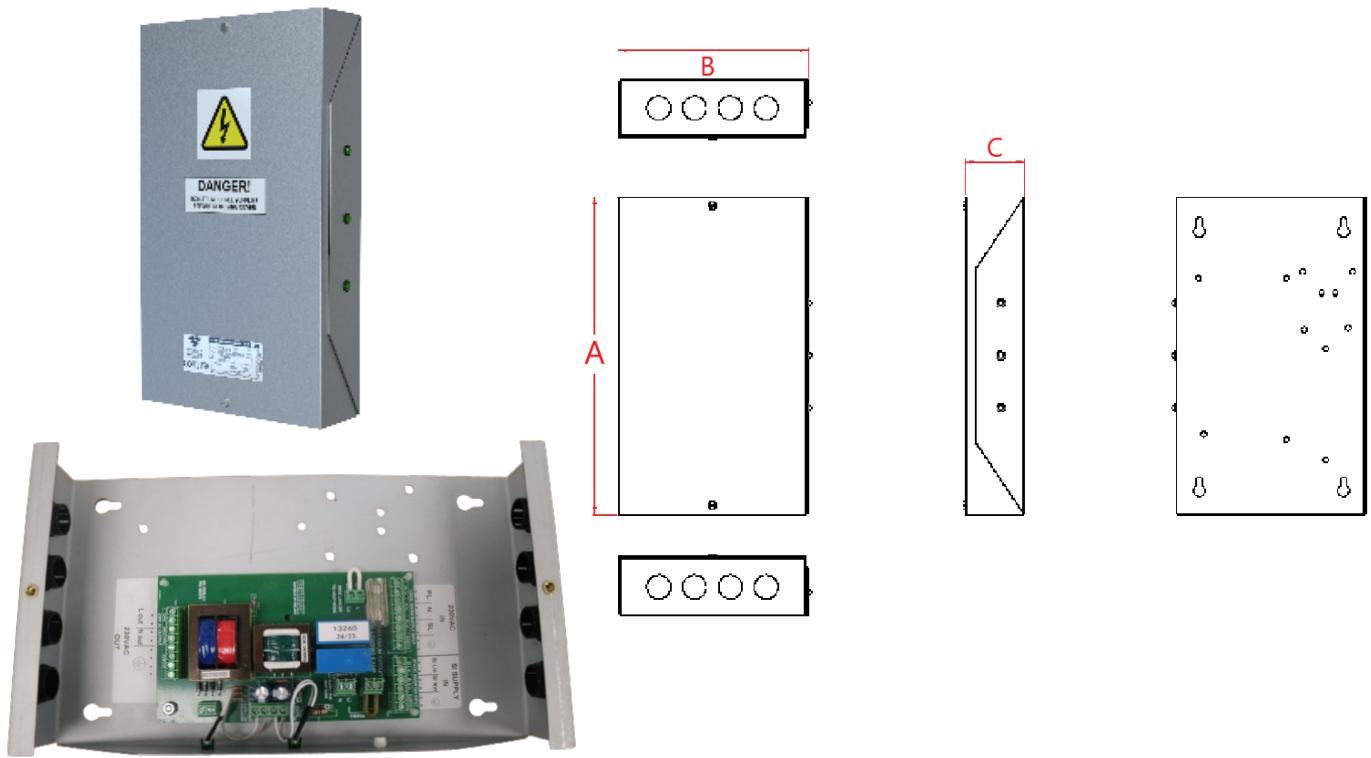

# Static Changeover unit



Example of SICOU1/SCM1 Model

|  |   |   |                              |                    |   |
|--|---|---|------------------------------|--------------------|---|
| Built-in<br>Circuit Fuse<br><b>10A</b>       | Changeover<br>Power<br>Rating<br><b>8A</b>  | Cable Entry<br>Points<br><b>8</b>               | Wall &<br>Ceiling<br>Mounted | Surface<br>Mounted | <br><b>0.7Kg</b> |
| Optional<br>In-line<br>Limiter<br><b>10A</b> | <br><b>IK 10</b> | Mains Input<br>Voltage<br>230-240VAC<br>50/60Hz | Class<br><b>I</b>            | <b>IP 20</b>       | <b>6Y</b><br>Warranty   |

Static Changeover Units are essential components in a Switch Maintained Static Inverter System, enabling Emergency Luminaires to be powered by a Local Switched Supply during normal operation.

In the event of a Local Supply failure, the Changeover Units switch the Luminaires to the Static Supply, ensuring uninterrupted emergency lighting. This critical functionality ensures the safety and security of occupants in a building during power outages.

## Materials

Housing: Un-Painted Folded Steel

## Warranty

Standard Warranty: 6 Years  
 Alternative Warranty: 10 Years  
 Add /10Y to Order Code

| Number of Monitored Circuits | Order Code  | Mode of Operation | Dimensions (mm) |     |    |
|------------------------------|-------------|-------------------|-----------------|-----|----|
|                              |             |                   | A               | B   | C  |
| 1                            | SICOU1/SCM1 | Changeover Unit   | 280             | 170 | 50 |
| 2                            | SICOU1/SCM2 | Changeover Unit   | 280             | 170 | 50 |
| 3                            | SICOU1/SCM3 | Changeover Unit   | 280             | 170 | 50 |
| 4                            | SICOU1/SCM4 | Changeover Unit   | 280             | 170 | 50 |